

Stiftplatte C

Bauform C

Industrial / DIN 43 650 / EN 175301 - 803

Base connector C

Form C

Kontaktabstand Contact spacing	8 mm (DIN/EN) 9,4 mm (Industrial)
Nennspannung Rated voltage	250VAC / 300VDC
Dauerstrom Operating current	6 A
Max. Strom Max. current	10 A
Max. Leiterquerschnitt Max. wire gauge	0,75 mm ²
Anschlußart Termination	Löten solder
Gehäusematerial Housing material	PA + 30 % GF
Kontaktmaterial Contact material	Cu Zn (Ag)
Temperaturbereich Temperature range	-40° C ... + 125° C

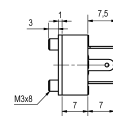
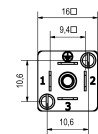
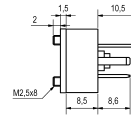
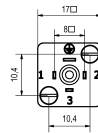

Befestigung Mounting	Polzahl Contacts	Artikel Nr. Part No.	Artikel Nr. Part No.
		8 mm (DIN/EN)	9,4 mm (Industrial)
M2.5x8,5mm	2+PE	615200	
M2.5x8,5mm	3+PE	615300	
M3x8,5mm	2+PE		629200
M3x8,5mm	3+PE		629300

Technische Änderungen vorbehalten, Maßzeichnungen auf Anfrage / Specifications are subject to change without notice, scale drawings on request